



Portable Power Bank

User Manual

Model: E40JA
Capacity: 4000mAh

- All brand of telephone and communication equipment
- Hand-held GPS navigation system
- PSP NDS NDSI GBA Game Player
- MP3 MP4 Digital camera Mini acoustics

 Designed & Made in China



-----Please read instruction carefully before using

Product introduction

Thank you for choosing this large capacity power bank. I believe that it will bring you great convenience. Please read the following instructions carefully before using, so that it can bring you a good operate experience and you can enjoy the right of after-sales service to a large extent.

The excellent polymer is adopted to make the normal circulation service life reaches or even more than 1000 times. Power bank built-in protection circuit against over-current, over-heat and over-voltage, which ensures security. New type of acrylic makes it more fashionable, light and less subject to damages.

Description

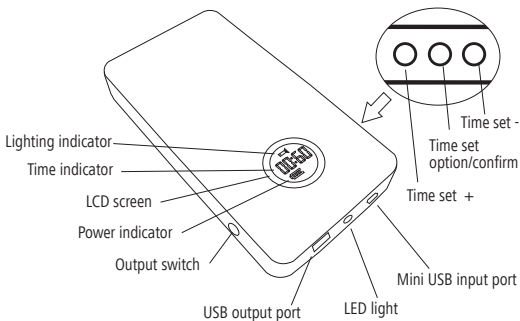

1 ▶▶

Usage method

Please make sure the charge voltage of your electric device is between DC4.8V to 5.5V before your next step, then choose the suitable connector for your device.

- Take out your power bank and the USB cable. Link the electric device and power bank correctly. Double-click the output switch, then the backlight of LCD screen will display "output". At that time you can see the charging status of your device. It means the power bank works properly.
- When your electric device is full charged or incorrectly connected. The self-test function would be aroused and the output will shut off automatically after 20 seconds.

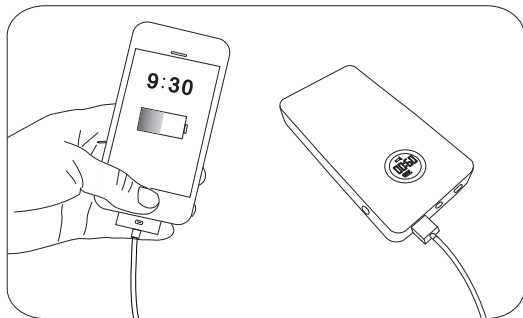

2 ▶▶

- Open the LED light: Press the power switch for about 2 seconds, LCD screen will display "☞" which means LED light is up. Repet operation, LED light would be turned off.
- Time adjustment: Press the "time set option/confirm" for about 2 seconds and then press time set + or time set --to adjust the "hour" and repet the last step to adjust the "minutes" . Then press time set button again to save and exit.

Power indicator



80% - 100%

60% - 80%

30% - 60%

1% - 30%

- Power light shows the percentage of the left power.

- Charge your power bank: You can use USB and Micro USB connector to charge the power bank from USB adaptor or PC's USB port or Car charger. When all power indicators light, It means your power bank is fully charged. It will stop charging automatically.

Note:

The charger on this picture do not included in this package.

3

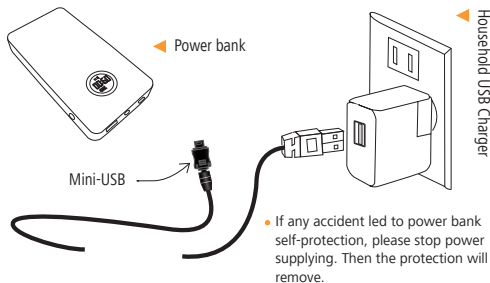

LCD screen display "☞" and keep flashing means charging. When display "☞" and stop flashing means fully charged.

Connector & Cables (accessories)

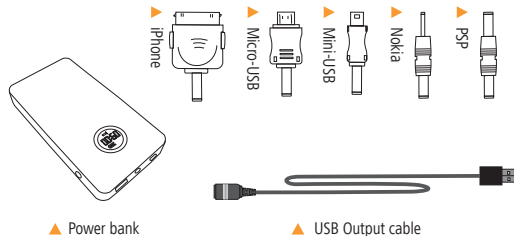

4

Specifications

Battery Cell type	3.7V 4000mAh 14.8Wh
Rated input	2V 2000mA (max)
Input port	5V 1000mA
Charging time	5-6 hours
Product Dimension	110*60*14mm
Package size	176*95*30mm
External material	engineering plastics, acrylic
Operating temperature	-10°C ~ 50°C
Net weight	115g
Gross weight	250.8g
Perform standard	GB493.1-2001

Maintenance

1. Please charge it every 3 months when not using.
2. Please keep it away from water, moisture and corrosive chemicals.
3. Don not clean it using chemicals or detergent. Just wipe it gently using a soft cloth with soapy water.
4. If any problem raises, please take the supply to local customer service center for help.

Notice

Please read the notice below carefully before using.

Security Usage Attentions



Behaviors strictly prohibited

This is a hi-tech electronic product. Do not disassemble, refit or reassemble it; do not beat or crash it; do not short-circuit; do not put it into water or fire otherwise it may be damaged and may even endanger your life.



Attentions of security usage

Please use it in a cool and dry environment or the self-protection function may be aroused to stop charging. Avoid direct exposure to sunshine and rain. Please don't put flammable or explosive items near it and keep it away from children in case of any unexpected accidents. Please discard it according to the local law.



Do not use non-USB charger to charge it